



Installation

Kit P/N:

TA-5102P

Make:

Chevrolet

Model:

Cobalt SS

Year:

'05-'07

Engine:

L4-2.0L (sc)

Parts Identification:

- 1 Air filter (Pro Dry S™ TF-9010D)
- 1 Intake tube, upper 05-T51021P1
- 1 Intake tube, lower 05-T5102P2
- 1 Coupling, elbow 05-00136
- 1 Coupling, straight 05-00417
- 2 Clamp #048
- 2 Clamp #044
- 1 Wavy washer M6
- 1 Flat washer M6
- 1 Nut M6
- 2 Screws M4
- 1 Rubber trim @ 13"L

Tools Required:

- 10mm socket or wrench
- Ratchet w/ extension
- Phillips screw driver
- Flat head screw driver
- 5/16" nut driver
- Pliers

Note: Read instructions before installation and have tools ready.

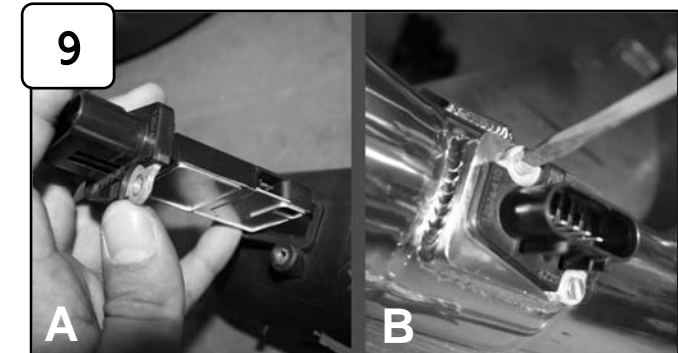
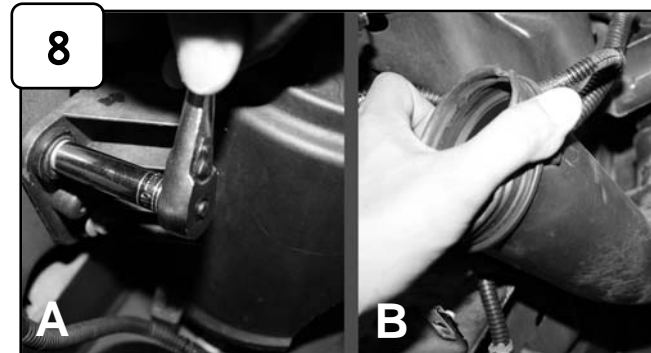
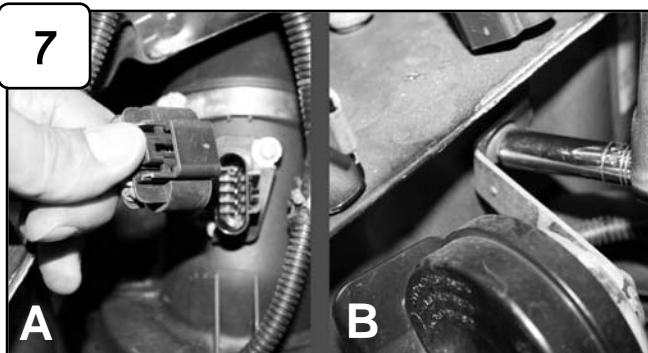
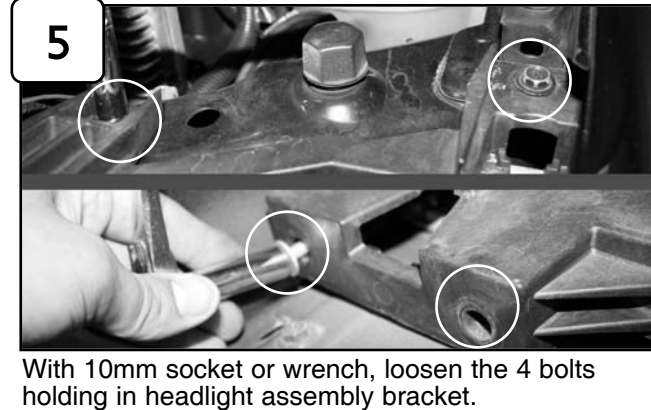
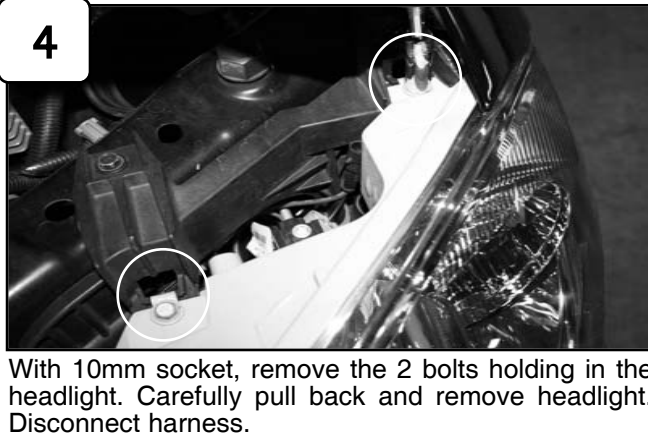
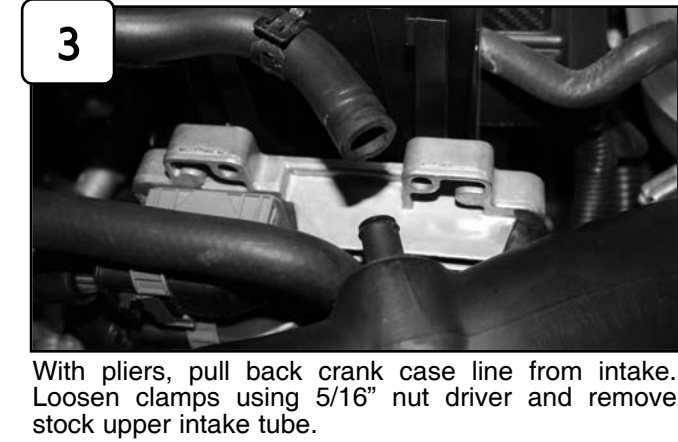
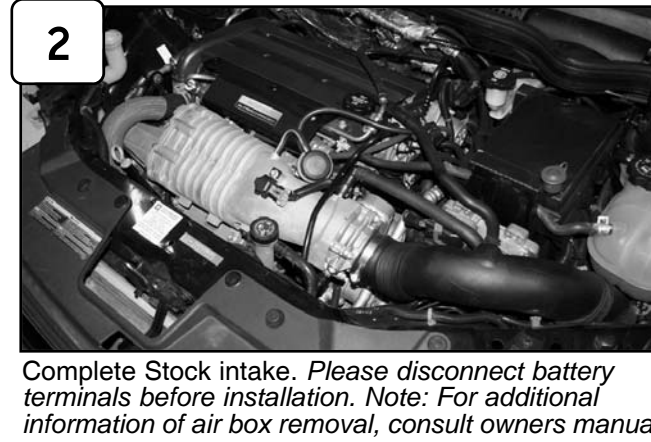



Accessories



Replacement Filter P/N:
TF-9010D



Pre Filter P/N:
TP-7011B

Note: Filter Cleaning: When cleaning your **Pro Dry S™** filter, be sure to use only "Restore Kit" (Takeda P/N: TP-7016C **Pro Dry S™** cleaner only.)

Pro Dry S™ cleaning:
see cleaning instruction sheet TF-9000I.

For replacement part(s) or "Restore Kit" please log on to takedausa.com
P.O. Box 1719 Corona CA, 92878

10



Install provided rubber trim into hole cut out. *Note: This will prevent scratches for further installation.*

11



Attach elbow coupling and straight coupling to tube with clamps. Do not tighten.

12



Install upper intake tube assembly and position. Do not tighten.

13



Install lower intake tube assembly and position to coupling. Position bracket to factory mounting stud used for stock air box. Do not tighten.

14



Position coupling and tighten clamps using 5/16" nut driver. Attach crank case line to intake tube using pliers.

15



Tighten all remaining clamps using 5/16" nut driver.

16



With provided M6 nut, wavy and flat washer secure bracket on lower intake tube using 10mm wrench.

17



Reconnect MAF sensor harness. If optional pre-filter was purchased, attach pre-filter to air filter and install. Tighten clamp using 5/16" nut driver. Re-install horn. Re-install headlight assembly (reverse steps 5-8). Re-connect battery terminals.

18



The installation of your Takeda performance intake is now complete. Please check all components and re-tighten if necessary. Reconnect battery terminals. Thank you for choosing Takeda!